

36x80 Frame ~ 5760 sq.ft.

Frame Specifications:

36x80 Frame w/ full loft

20' wall height

9/12 roof pitch w/ 2' overhang

32' dustpan dormer one side

4/12 roof pitch w/ 2' overhang

Up to three door openings for 14' first floor

Frame Materials:

Full dimension, band sawn hemlock timbers, pre-cut ready to assemble

4x6 sill, gable end posts

5x5 knee braces

6x6 posts and queen posts

6x8 collar ties

6x10 loft joists, door headers

6x12 carry beams for loft, and rafters

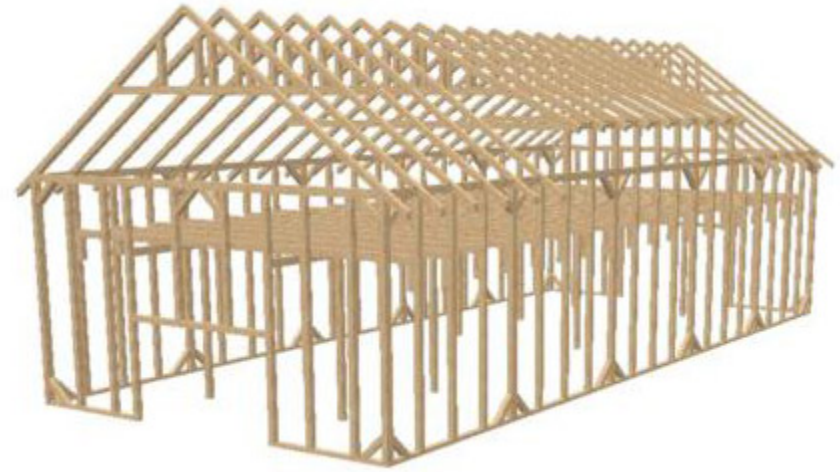

Includes:

Hardware to assemble timber frame, 2-D/3D CAD assembly prints, UV blocker applied to prevent discoloration, In-State Delivery

Frame Total - \$32,186